

Executive Committee on Teaching and Education (ECOTE)

Bob S Carter, MD PhD

Professor and Chair

MGH Department of Neurosurgery

ECOTE Chair



MASSACHUSETTS
GENERAL HOSPITAL



MASSACHUSETTS GENERAL
PHYSICIANS ORGANIZATION

What is ECOTE?

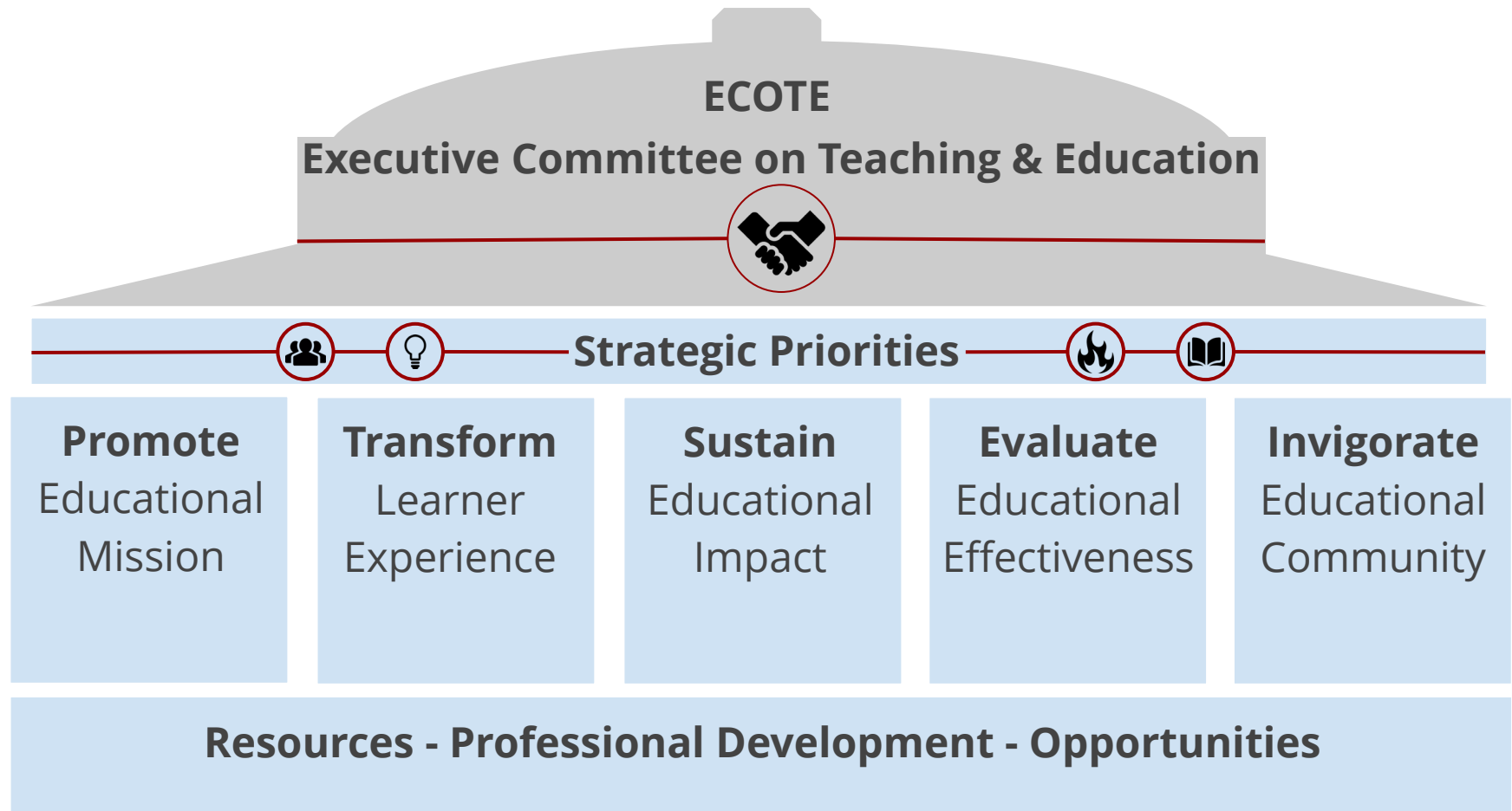

Executive Committee On Teaching and Education (ECOTE)

- Bob Carter, MD, PhD[^] (*Chair*)
- Mitchel Harris, MD[^] (*Chair Elect*)
- David Brown, MD
- W. Gerald Austen, MD
- Guardia Banister, RN, PhD, FAAN[^]
- Catherine Benacchio, RN, MSN
- Lori Berkowitz, MD
- Joseph Betancourt, MD
- Robert Birnbaum, MD, PhD
- Gino Chisari, RN, DNP
- John Patrick Co, MD, MPH
- Marcela del Carmen, MD
- Brian French, RN, PhD
- James Gordon, MD, MPA[^]
- Mary Hanifin, MBA
- John Herman, MD
- Alex Johnson, PhD, CCC-SLP
- John Marshall, PharmD, BCPS, BCCCP, FCCM
- Elizabeth Mort, MD, MPH
- Eric Nadel, MD
- Lisa Neville
- Lucy Ogbu-Nwobodo, MD, MS, MAS
- Nikhil Panda, MD
- Koren Phillips, MBA[^]
- Roy Phitayakorn, MD, MHPE (MEd), FACS
- Ann Prestipino, MPH[^]
- Carlyene Prince Erickson
- Alberto Puig, MD, PhD[^]
- Daniel Saddawi-Konefka, MD, MBA
- Noelle Saillant, MD
- Darlene Sawicki, NP
- Pamela Schaefer, MD, FACR
- Blake Rainie Slack, CNM, WHNP, MS
- Avik Som, MD, PhD
- Theodore Stern, MD
- Ravi Thadhani, MD, MPH
- Carlos Torres, MD
- John Kevin Tucker, MD
- Debra Weinstein, MD[^]
- Carey York-Best, MD

Resources Available to You

- **Research Support**
 - Education Research Grants
 - One-on-One Research Consultations
 - Medical Education Research Certificate Workshops
 - Education Research Seminar Series
 - Investigator Forums
 - Health Professions Education Research prize at MGH Clinical Research Day
- **Teaching Support**
 - Education Scholars Program (course tuition)
 - Monthly Education Forum
 - Visiting Professors
 - Webcast of HMS Academy Medical Education Grand Rounds
 - Biennial ECOTE Symposium

For additional information regarding resources:

<http://apollo.massgeneral.org/ecote/>

One-on-One Research Consultations

ECOTE is pleased to sponsor a team of educational researchers, available to consult, mentor, and catalyze educational research and educational research careers. Meet the team and contact them for consultation:



Emil Petrusa, PhD

Email: epetrusa@mgh.harvard.edu



Yoon Soo Park, PhD

Email: yspark@mgh.harvard.edu



Michael G. Healy, EdD

Email: mghealy@mgh.harvard.edu



MASSACHUSETTS
GENERAL HOSPITAL



MASSACHUSETTS GENERAL
PHYSICIANS ORGANIZATION

MGH Learning Laboratory



MASSACHUSETTS
GENERAL HOSPITAL



MASSACHUSETTS GENERAL
PHYSICIANS ORGANIZATION

The MGH Learning Laboratory seeks to ensure that every MGH trainee, provider, and team has regular opportunities for dedicated clinical practice and feedback in a risk-free environment.



- Mission: To enhance patient safety through routine practice for expert performance.



MASSACHUSETTS
GENERAL HOSPITAL



- Vision: To fully integrate clinical simulation as a quality and safety tool in health care.



MASSACHUSETTS GENERAL
PHYSICIANS ORGANIZATION



Carl Blesius, MD
Lab of Computer Science
Educational Technology



James Gordon, MD, MPA
Director



Michael G. Healy, EdD
Education Researcher



Sara Midwood
Administrative Coordinator



Rebecca Minehart, MD, MSHPE
Faculty Lead
Operating Room Strategic Initiatives



Michael Sampson
Surgical Simulation Specialist



Yoon Soo Park, PhD
Director, Health Professions
Education Research



Emil Petrusa, PhD
Faculty Lead
Academic Development



Koren Phillips, MBA
Executive Director
Teaching and Education



Patrick Smithedajkul, MD
Faculty Lead
Community Outreach



Wayne Stathopoulos, NREMT
Simulation Specialist



Suresh Venkatan, MBBS
Simulation Specialist



Website: www.massgeneral.org/learninglab
Email: MGHSimulation@partners.org

The MGH “Hub and Spoke” Model

A Comprehensive Blend of Central and Distributed Training



The Learning Lab “Ward”, highly adaptable for a variety of simulated learning experiences



Multiple, easily accessible, in-situ simulation spaces throughout the hospital

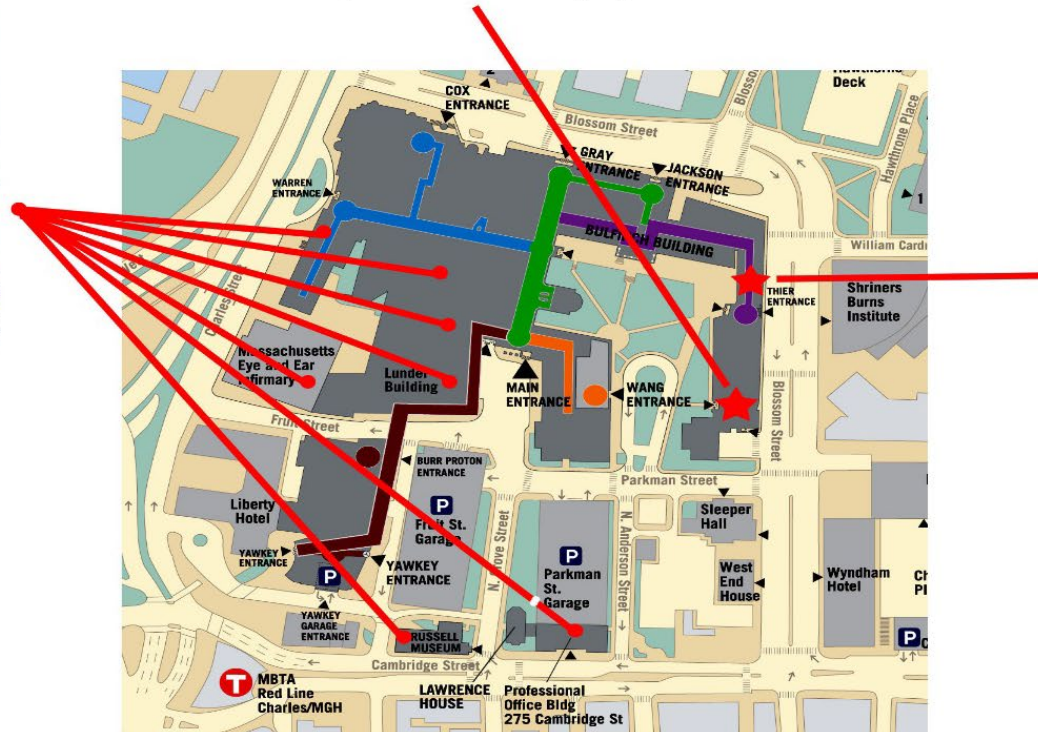

The Learning Lab’s fully functional simulation surgical suite

MGH Learning Lab Resources

- **High-Fidelity Mannequins for medical and surgical scenarios**
 - SimMan (Adult)
 - SimJunior (Child)
 - SimBaby (Infant)
 - Gaumard Victoria (OBGYN)
- **Task Trainers for Skill Acquisition (examples of trainers available)**
 - Lumbar Puncture
 - Paracentesis
 - Thoracentesis
 - Central Line Insertion (IJ, Subclavian, Femoral)
 - IV Arms
 - Arterial Line
- **Faculty Development Opportunities**
 - Scenario/Case Development Assistance
 - Education Research

For more information regarding the Learning Laboratory, please reach out to us at mghsimulation@partners.org

